

Kawasaki J 300 '17-19

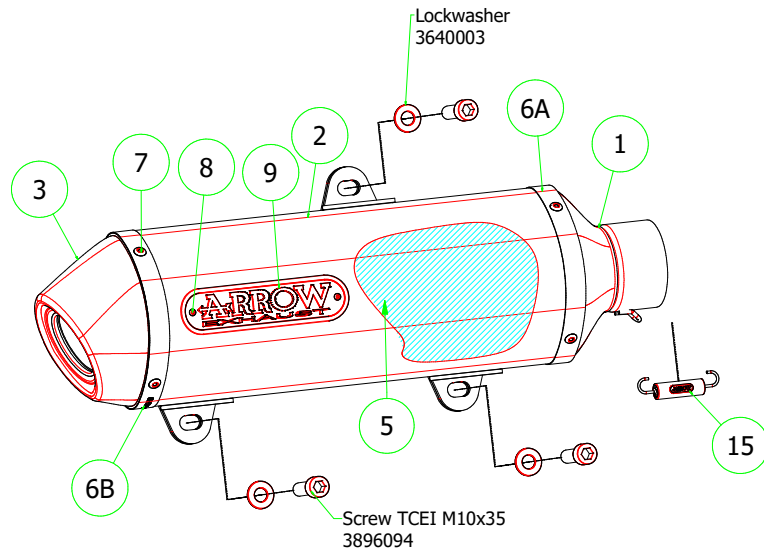

53532AN Homologated Aluminium - Inox

53532ANN Homologated Aluminium - Inox "Dark"



53079MI Racing Collector

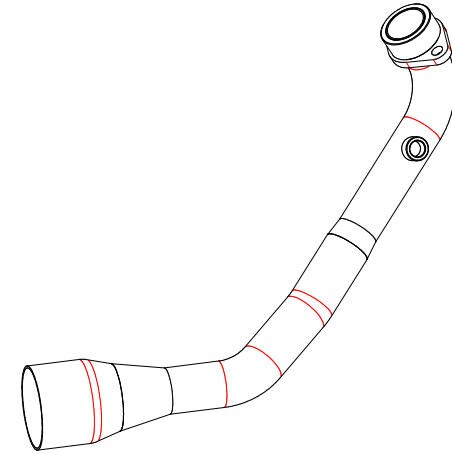

53532XN Homologated Nichrom

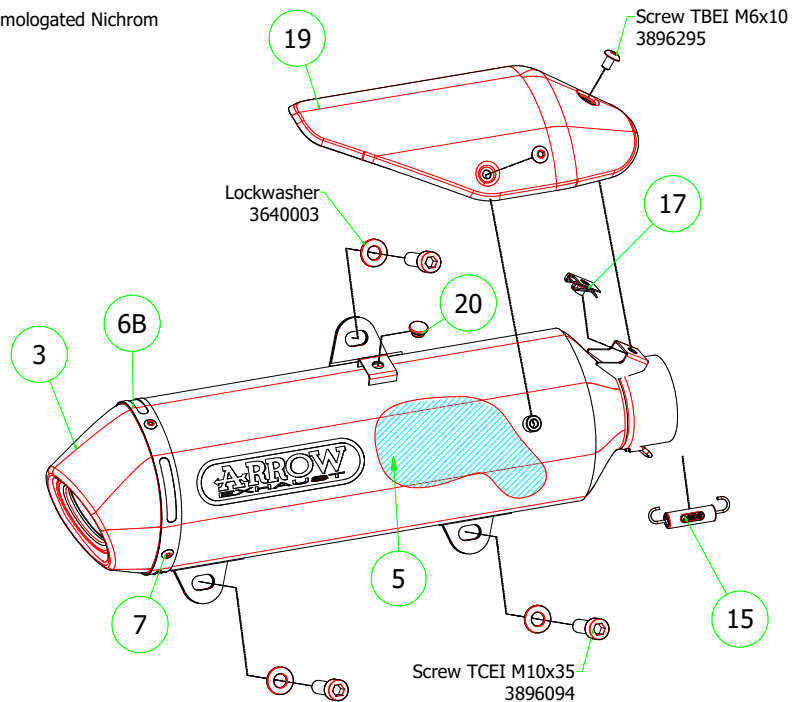

53079KZ Catalytic Homologated Collector

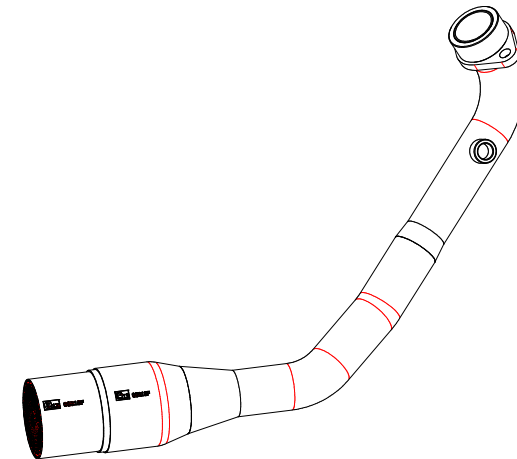

PARTI DI RICAMBIO / SPARE PARTS

ID	DESCRIZIONE / DESCRIPTION	53532AN cod	53532ANN cod	53532XN cod
1	Assieme anteriore / <i>Front assembly</i>	5035435	5035435	
2	Corpo Marmitta / <i>Silencer Sleeve</i>	5257379	5257378	
3	Assieme Posteriore / <i>Rear assembly</i>	5009957	5009957	5009957
5	Materiale fonoassorbente / <i>Sound-absorbant material</i>	5690196	5690196	5690196
6A	Fascetta di Serraggio Anteriore / <i>Front Strap For Rivets</i>	5495058	5495503	
6B	Fascetta di Serraggio Posteriore / <i>Rear Strap For Rivets</i>	5495058	5495503	5495504
7	Rivetto inox mm 4.8 / <i>Stainless Steel 4.8 mm Rivet</i>	3608011	3608011	3608011
8	Rivetto allum.mm.3.0 / <i>Aluminium 3.0 mm Rivet</i>	3608021	3608021	
9	Targhetta Arrow / <i>Arrow Plate</i>	5855109	5855109	
10	Silenziatore Interno / <i>Db Killer</i>			
11	Seeger / <i>Retain Clip</i>			
15	Molla / <i>Spring</i>	5281003	5281003	5281003
17	Inserto Rapid Nut / <i>Caged nut insert</i>			3245005
19	Protezione / <i>Heat Shield</i>			5683141
20	Gommino / <i>Rubber</i>			3240057
22	Tappo Sonda Lambda / <i>Lambda Sensor Plug Bolt</i>			